

Universal Torque Arm

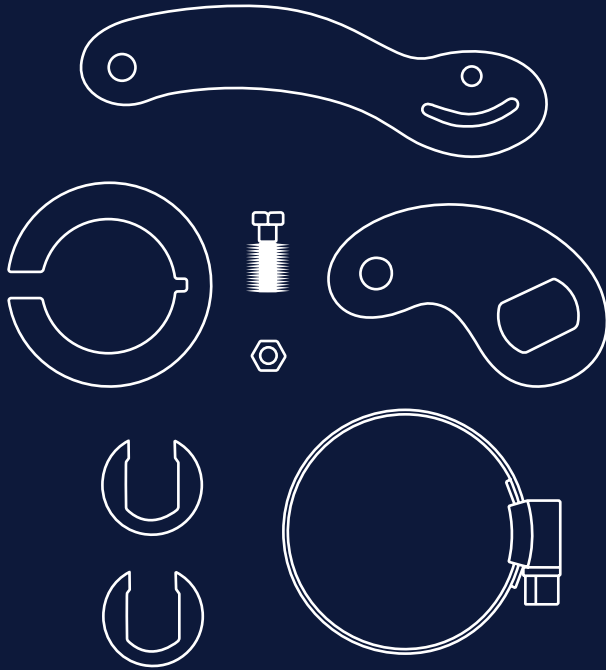

00

Table of Contents

01 About p.3

02 Installation p.4

1. About

A torque arm is an additional piece of metal which ensures that your axle is securely held in place.

It is designed for bikes with old forks (30+ years), carbon forks, or narrow forks. They add strength to your bike and keep your Swytch motor wheel in place.

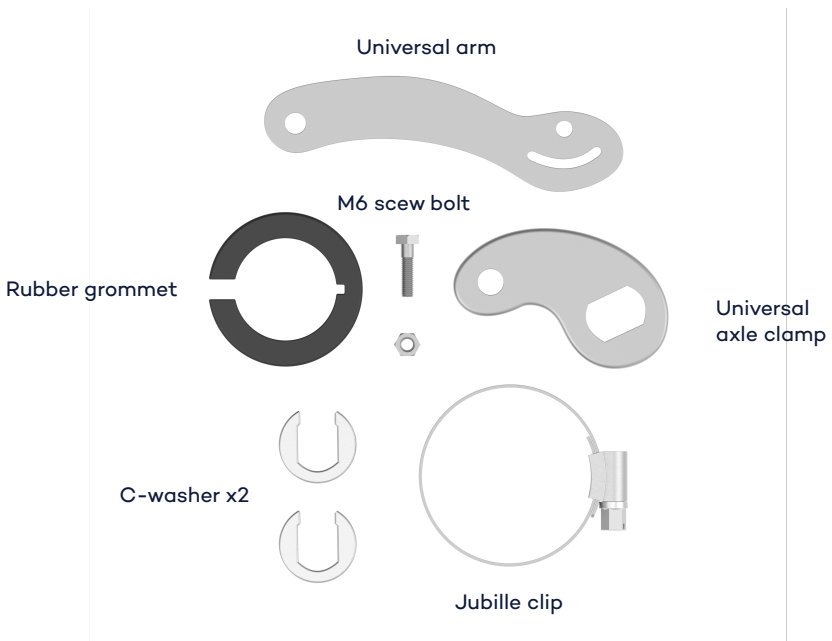

2. Installation

- 1.1 Fit the torque arm over a tightly fastened axle nut, on the side opposite the motor wheel cable.
- 1.2 Tighten the jubilee clip on the axle.
- 1.3 Break off the excess clip by bending it back and forth.
- 1.4 Use the second nut to secure the torque arm to the axle.

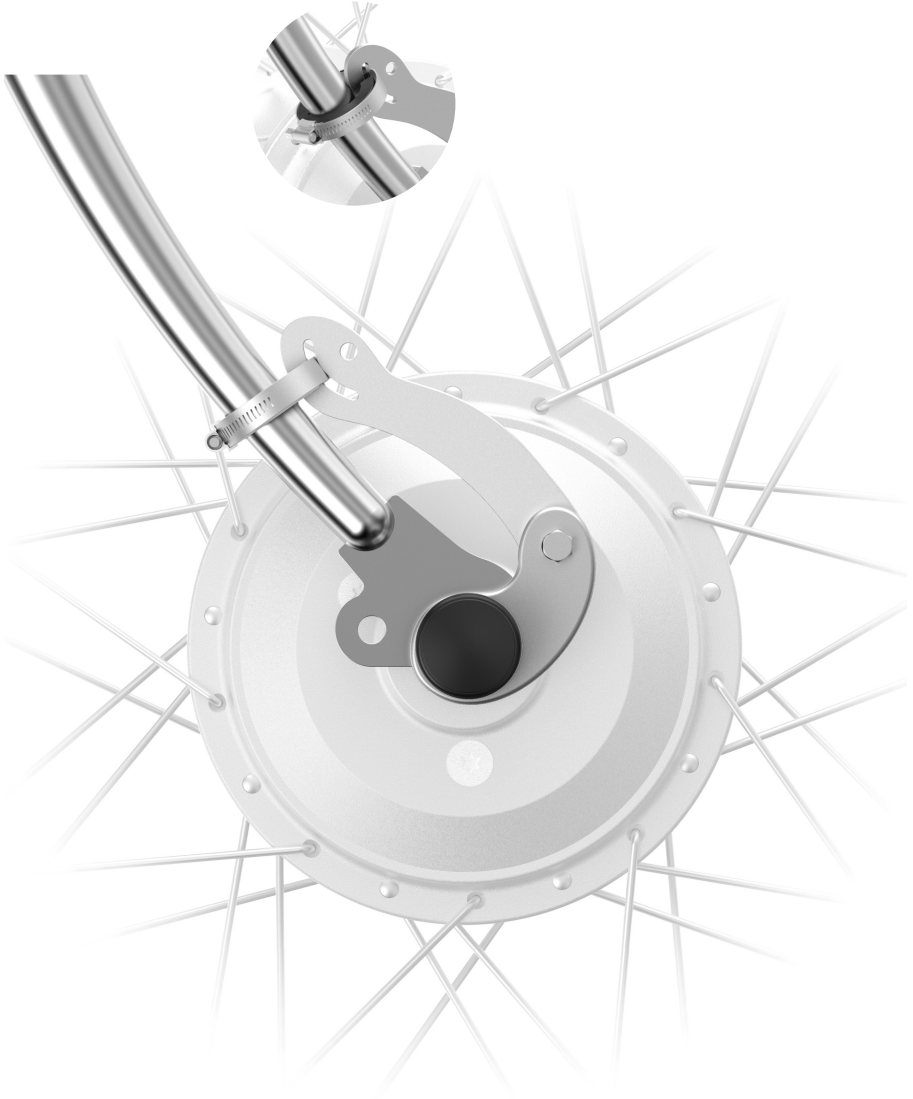

 swytch